

COMPRESSION ELBOW WITH MALE THREADED OFFTAKE

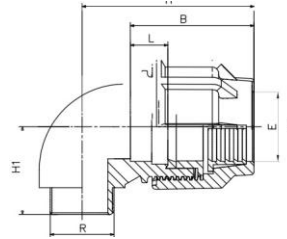

	Size	Code	g	SP	B	C	E	L	H	H ₁
1	20x 1/2"	CME20X050BKA	48	200	40	45	21	20	71	50
2	25x 3/4"	CME25X075BKA	82	100	61	53	27	20	82	59
3	32 x 1"	CME32X100BKA	124	70	66	65	34	26	88	60
4	40 x 1 1/4"	CME40X125BKA	270	30	85	82	44	26	114	72
5	50 x 1 1/2"	CME50X150BKA	376	18	97	93	54	27	126	77
6	63 x 2"	CME63X200BKA	676	12	111	117	64	33	155	80

Note : SP - Standard Packing Quality, g - Individual fitting weight in gms

Kimplas Compression fittings PN 16 and are designed to use with all types of Polyethylene Pipes i.e. HDPE, MDPE and LDPE (grades PE100, PE80, PE63, PE 25 etc.). Unique design of the fitting facilitates insertion of the pipe into fitting without disassembling the fitting. The working temperature range of the fittings is - 5° to+ 40°C and the fittings are recommended for cold water services only. The fittings are ideally suited for Drip and Sprinkler Irrigation piping networks.

Standards:

Pipe compatibility ISO:4427-2,EN:12201-2,IS:4984,DIN:8074, IS:12786
Dimensions, Features & Functional Tests:ISO:3501,ISO:3503,ISO:3459
Threading: IS:554, ISO:7/1, BS:21, DIN:2999
Complies with ISO:14236

Common Applications:

For connecting Sprinkler Irrigation mains, sub-mains and laterals
For connecting Drip Irrigation mains and sub-mains.
For connecting fertigation equipment like Venturi, Fertilizers Tank and Dozing pump
Enables speedy laying of Pipes in emergencies and ideal for semi permanent Sprinkler Systems

Installation :

Joint preparation must be done as specified in the installation instructions. Pipe ends must be cut square and burr-free before using with the fittings. Chamfer may be provided on the pipe end to facilitate ease of pipe insertion. To install the fitting, there is no need to open the nut and other components of the fitting. To install the fitting, just loosen the nut by three to four turns, insert the pipe into the fitting until the pipe crosses the rubber seal and stops at the pipe stop. Then tighten the nut by hands only. For fittings of size 40 mm and above a wrench recommended by Kimplas may be used for additional tightening. The nut should be closed tightly, however there is no need for the nut to actually meet the body. Complete Installation Manual may be downloaded.

Advantages :

The body is made of Polypropylene and designed with modular construction and axial reinforcement
The nut made of Polypropylene, with its sturdy design holds the pipe-fitting assembly intact with continuous working pressures upto 16 Bars
The grip ring made up of POM (Poly-acetal) prevents the pipe being pulled out from the fitting.
The PP (Packing Pressure) Bush exerts thrust on the rubber O'-Ring/Gasket, compresses on pipe & fitting body to ensure leak-tightness
Rubber O'-Ring / Gasket prevent leakage under internal pressure as well as under external pressure as in case of vacuum and/or suction
Plastic & rubber materials conform to the Standard requirements for use with irrigation water
For connecting to BSP threaded GI Pipe and fittings and brass/ PVC Valves etc
Higher penetration of Pipe in the fittings enables for proper alignment
Clearance-Fit for ease of installation and repairs
Tolerance fit to take care of ovality of coiled pipes
Permanent Batch Indicator, Size, PN rating and Raw Material
Grade marking for ease of traceability
Compact but sturdy design for ease of installation & trouble free service