

## COMPRESSION MALE THREADED ADAPTOR(MTA)

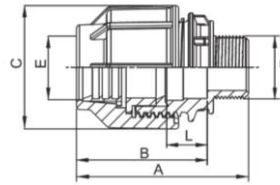

Size	Code	g	SP	A	B	C	E	L
20mm x 1/2"	MTA20X050BLA	225	225	72	51	45	21	20
25mm x 3/4"	MTA25X075BLA	60	150	79	57	53	27	20
32mm x 1"	MTA32X100BLA	91	85	93	65	65	34	24
40mm x 1.1/4"	MTA40X125BLA	196	40	112	85	82	44	25
50mm x 1.1/2"	MTA50X150BLA	258	25	124	97	93	54	28
63mm x 2"	MTA63X200BLA	465	16	157	122	117	64	42

**Note** SP - Standard Packing Quality, g - Individual fitting weight in gms

Kimplas Compression fittings, PN 16 and are designed to use with all types of Polyethylene Pipes i.e. HOPE, MOPE (grades PE100, PE80, PE63, etc.). Unique design of the fitting facilitates insertion of the pipe into fitting without disassembling the fitting.

The working temperature range of the fittings is - 5° to+ 40°C and the fittings are recommended for cold water services only. The fittings are ideally suited for connecting House Service Connections in Drinking Water Distribution piping networks. For exact recommendations on the applications and use, refer Kimplas Technical Specifications Manual.

### Standards:

- Pipe compatibility ISO :4427-2, EN:12201-2, IS: 4984, DIN: 8074
- Dimensions, features & functional tests: ISO:3501, ISO:3503, ISO:3459
- Complies with ISO:14236

### Common Applications:

- PE Pipe to PE pipe connection during laying
- Pipe connections in areas difficult to access
- Repairing localized damages on pipes Connections
- Pipe Connections of permanently laid down (immovable) pipes
- Reinforcements of squeezed or kinked portions of pipe Connections to permanently laid down (immovable) pipes
- Enables speedy laying of Pipes in emergencies and ideal for semi permanent Water Supply Systems

### Installation :

Joint preparation must be done as specified in the installation instructions. Pipe ends must be cut square and burr-free before using with the fittings. Chamfer may be provided on the pipe end to facilitate ease of pipe insertion. To install the fitting, there is no need to open the nut and other components of the fitting. To install the fitting, just loosen the nut by three to four turns, insert the pipe into the fitting until the pipe crosses the rubber seal and stops at the pipe stop. Then tighten the nut by hands only. For fittings of size 40 mm and above a wrench recommended by Kimplas may be used for additional tightening. The nut should be closed tightly, however there is no need for the nut to meet the body. Complete Installation Manual may be downloaded.

### Advantages :

- The body is made of Polypropylene and designed with modular construction and axial reinforcement
- The nut made of Polypropylene, with its sturdy design holds the pipe-fitting assembly intact with continuous working pressures upto 16 Bars
- The grip ring made up of POM (Poly-acetal) prevents the pipe being pulled out from the fitting
- The PP (Packing Pressure) Bush exerts thrust on the rubber O'-Ring / Gasket, compresses on pipe and fitting body to ensure leak-tightness
- Rubber O'-Ring/ Gasket prevent leakage under internal pressure as well as under external pressure as in case of vacuum and/or suction
- Plastic & rubber materials conform to the Standard requirements for use with potable Water for Human consumption
- Higher penetration of Pipe in the fittings enables for proper alignment
- Clearance-Fit for ease of installation and repairs
- Tolerance fit to take care of ovality of coiled pipes
- Permanent Batch Indicator, Size, PN rating and Raw Material Grade marking for ease of traceability
- Compact but sturdy design for ease of installation and trouble free service

