

## Brass Ferrule Regulator for Water in House Service Connection

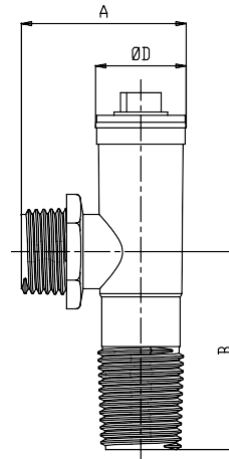

Nominal size	ID mm	Product Code	SP	g	A	B
1/2"	15	BRASSREGFERRULE050	240	137	40	48
3/4"	20	BRASSREGFERRULE075	50	394	50	73
1"	25	BRASSREGFERRULE100	35	415	53	77
1 1/4"	32	BRASSREGFERRULE125	-	-	57	83
1 1/2"	40	BRASSREGFERRULE150	25	-	68	96
2"	50	BRASSREGFERRULE200	25	-	74	104

Note: SP= Standard Pack Quantity, g = Weight in Grams

Kimplas Brass Ferrule Regulator is manufactured in Brass. The Brass Ferrule can be directly fitted on KIMPLAS DI Saddle or PE Electrofusion Branch Tapping Saddles.

### Standards:

- Material complies with IS 319 Grade 1/2.
- Compatibility - DI Saddle, PE Electrofusion Branch Tapping Saddles
- Connection Threading - IS: 554 BSPT, ISO:7-1

### Common Applications:

- Regulating Water supply for House Service Connection (HSC).
- For maintaining uniform pressure for water distribution networks on undulating terrain

### Installation :

Joint preparation must be done as specified in the installation instructions. First, Hand tighten only then Use pipe wrench for proper tightening, Use sealants such as "Teflon Tape", "Safeda", "Hold Tight", Threads (Jute fibers) etc. wherever required. Complete Installation Instruction Manual may be downloaded.

### Advantages :

- Built in regulator for regulation of flows of water
- Pressure Rating - PN 10
- Easy to joint saves time on site
- No leakage
- Long Life
- Available in standard sizes



For details about our other products and specifications please refer the corporate website

Disclaimer : Kimplas reserve the right to modify product without prior notice, as part of its continual improvement programme. Whilst every effort is taken to ensure the accuracy of information contained in the data Sheet, Kimplas accepts no liability for matters arising as a result of errors or omissions.